



## Henry Court

Stanmore

£350,000

A one bedroom flat available chain free, in excellent condition in Stanmore Place.

The flat is on the top floor in a building with a lift and has an open plan kitchen/living room with a private balcony overlooking Stanmore marsh. There is also a large bedroom with built-in wardrobes, a family bathroom and built in hallway storage including a utility cupboard.

Stanmore Place is in an excellent location for Canon's Park tube station. On site is a gym, a children's playground, security and a 24 hour concierge. The flat also has an allocated car parking space in the secure on-site car park.

Leasehold of 999 years from 1st January 2009.  
Ground Rent of approximately £544 per year.  
Service Charge of approximately £2580 every six months.  
Harrow Council Tax Band C.

### Viewing

Please contact our Davidson Frost-Wellings Office on 020 8954 8806 if you wish to arrange a viewing appointment for this property or require further information.

- One Bedroom
- Excellent Condition
- Chain Free
- Private Balcony
- Gym and Concierge
- Leasehold
- Secure Parking
- Top Floor (with lift)



## Floor Plan

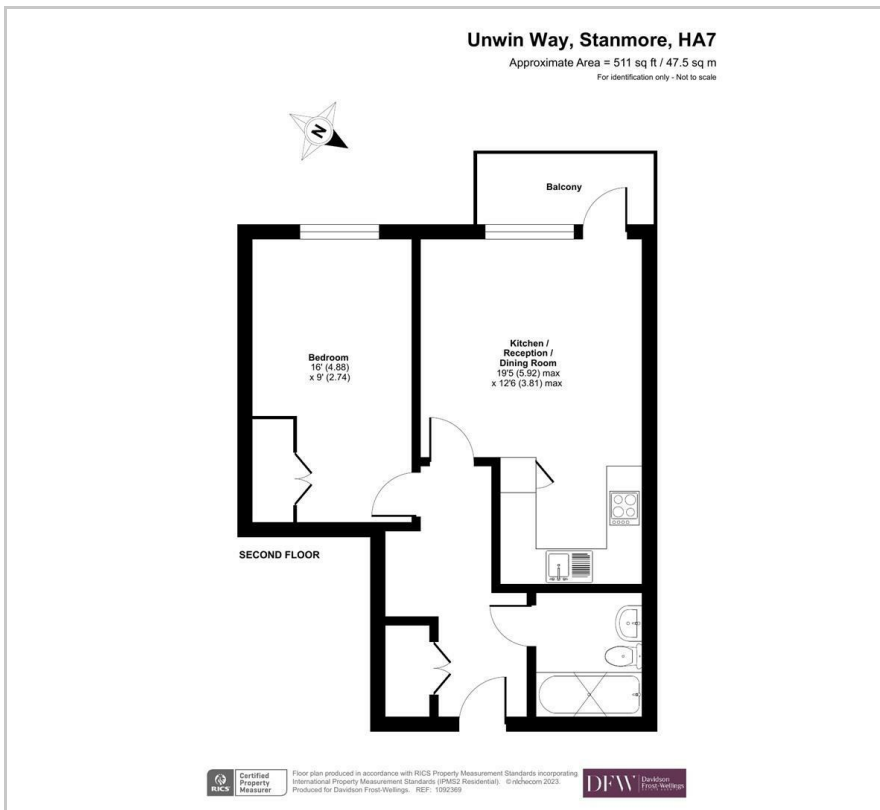

## Area Map

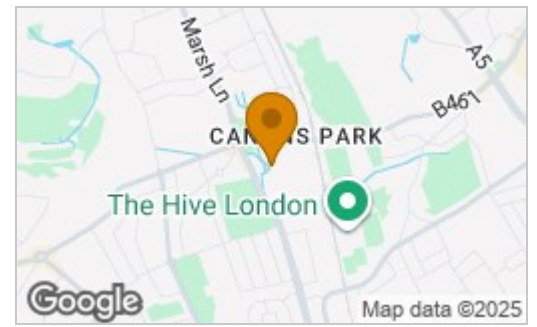

### Energy Efficiency Rating

	Current	Potential
<i>Very energy efficient - lower running costs</i>		
(92 plus) <b>A</b>		
(81-91) <b>B</b>		
(69-80) <b>C</b>	<b>79</b>	<b>81</b>
(55-68) <b>D</b>		
(39-54) <b>E</b>		
(21-38) <b>F</b>		
(1-20) <b>G</b>		
<i>Not energy efficient - higher running costs</i>		
<b>England &amp; Wales</b>	EU Directive 2002/91/EC	

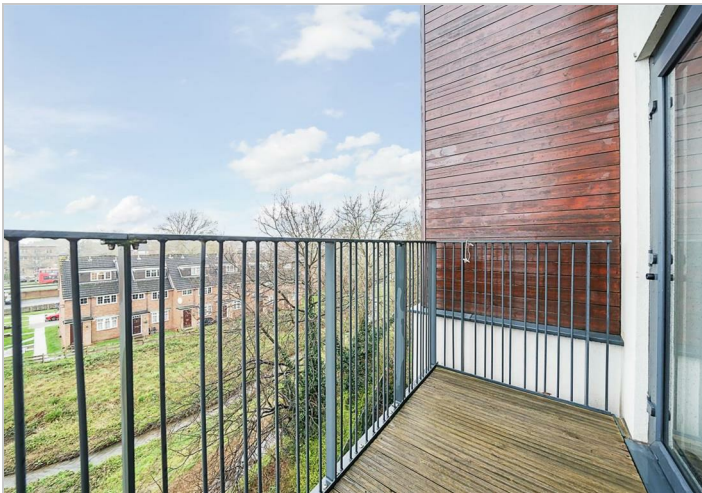

These particulars, whilst believed to be accurate are set out as a general outline only for guidance and do not constitute any part of an offer or contract. Intending purchasers should not rely on them as statements of representation of fact, but must satisfy themselves by inspection or otherwise as to their accuracy. No person in this firm's employment has the authority to make or give any representation or warranty in respect of the property.